

REACH & RoHS
COMPLIANT

1. OUTLINE DIMENSION:(UNIT:mm)/外形尺寸（单位：mm）

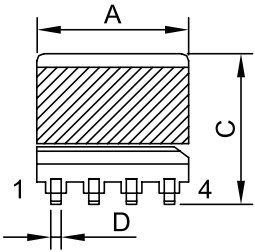

ELEVATION

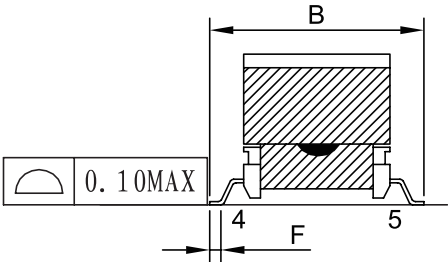

SIDE VIEW

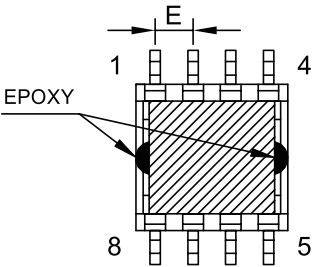

BOTTOM VIEW

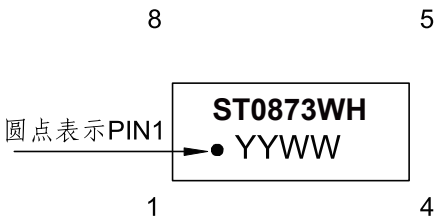

标签内容

- NOTE:
- 1.N1绕组不交叉.
 - 2.线包绝缘胶带为淡黄色,, 磁芯外包高温胶带.
 - 3.磁芯单边开气隙(装于PIN1-4侧), 外包5mm胶带2Ts.
 - 4.底部磁芯与线包空隙处点黑胶固定.(如图)
 - 5.产品不含浸.
 - 6.标签如上图所示,印字内容中YYWW代表年份与周期.

A	B	C	D	E	F
10.5MAX	9.5MAX	10.5MAX	0.70±0.1	2.5±0.3	0.75REF

VOOHU 苏州沃虎电子科技有限公司
Su Zhou Voohu Electronic Tech.Co.Ltd

TEL: +86 400 1048 018

WEB: WWW.WOHU-TEK.COM

TITLE:
变压器/TRANSFORMER

PART NO.:
ST0873WH

REMARK:

SIZE
A4

SACLE
1:1

SHEET
1/3

UNITS
MM[INCH]

REV
A0

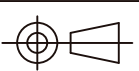

GENERAL TOLERANCES
UNLESS SPECIFIED

x±0.35
.x±0.30

.xx±0.25
.xxx±0.10

x°±3.0°
.x°±2.0°

.xx°±1.5°
.xxx°±1.0°

APPROVED BY:
Geoffrey.Song

CHECKED BY:
Elvis.Song

DESIGND BY:
Sunny.Xu

1	2	3	4	5	6	7	8																																										
REACH & RoHS COMPLIANT																																																	
2. CIRCUIT DIAGRAM/电气原理图				3. CONSTRUCTION DIAGRAM/内部结构图																																													
<div><div><div>PRI</div><div><div><div>1</div><div>2</div><div>3</div><div>4</div></div><div><div>N1,N4</div><div>N3</div></div></div><div><div>SEC</div><div><div><div>7,8</div><div>5,6</div></div><div><div>N2 12V 0.9A</div></div></div></div><div><div>●</div><div>START</div></div></div></div>				<div><div><div>PIN1-4</div><div>PIN5-8</div></div><div><div><div><div><div>N4</div><div>N3</div><div>N2</div><div>N1</div></div><div><div>2Ts</div><div>1Ts</div><div>1Ts</div><div>1Ts</div></div></div></div><div><div>CORE</div></div></div></div>																																													
4.WINDING INFORMATION TABLE/绕制明细表																																																	
<table><tr><th rowspan="2">绕组 WINDING</th><th colspan="2">挡墙胶带 MARGIN TAPE</th><th rowspan="2">起始-收尾 S - F</th><th rowspan="2">线材 WIRE</th><th rowspan="2">圈数 TURN</th><th rowspan="2">绝缘胶带 TAPE</th><th rowspan="2">备注 REMARK</th></tr><tr><th></th><th></th></tr><tr><td>N1</td><td></td><td></td><td>2--1</td><td>2UEW-H Ø0.18*1</td><td>16Ts</td><td>1Ts</td><td>密绕/CLOSE</td></tr><tr><td>N2</td><td></td><td></td><td>7,8--5,6</td><td>2UEW-H Ø0.18*4</td><td>8Ts</td><td>1Ts</td><td>密绕/CLOSE</td></tr><tr><td>N3</td><td></td><td></td><td>4--3</td><td>2UEW-H Ø0.13</td><td>8Ts</td><td>1Ts</td><td>疏绕/SPARSE</td></tr><tr><td>N4</td><td></td><td></td><td>2--1</td><td>2UEW-H Ø0.18*1</td><td>16Ts</td><td>2Ts</td><td>密绕/CLOSE</td></tr></table>								绕组 WINDING	挡墙胶带 MARGIN TAPE		起始-收尾 S - F	线材 WIRE	圈数 TURN	绝缘胶带 TAPE	备注 REMARK			N1			2--1	2UEW-H Ø0.18*1	16Ts	1Ts	密绕/CLOSE	N2			7,8--5,6	2UEW-H Ø0.18*4	8Ts	1Ts	密绕/CLOSE	N3			4--3	2UEW-H Ø0.13	8Ts	1Ts	疏绕/SPARSE	N4			2--1	2UEW-H Ø0.18*1	16Ts	2Ts	密绕/CLOSE
绕组 WINDING	挡墙胶带 MARGIN TAPE		起始-收尾 S - F	线材 WIRE	圈数 TURN	绝缘胶带 TAPE	备注 REMARK																																										
N1			2--1	2UEW-H Ø0.18*1	16Ts	1Ts	密绕/CLOSE																																										
N2			7,8--5,6	2UEW-H Ø0.18*4	8Ts	1Ts	密绕/CLOSE																																										
N3			4--3	2UEW-H Ø0.13	8Ts	1Ts	疏绕/SPARSE																																										
N4			2--1	2UEW-H Ø0.18*1	16Ts	2Ts	密绕/CLOSE																																										
<div><div>1.N1绕组不交叉.</div><div>2.PIN3,4脚同槽进出线.</div><div>3.N2绕组PIN5,6和7,8各挂2根线.</div></div>																																																	
<div><div>VOOHU</div><div>苏州沃虎电子科技有限公司</div><div>Su Zhou Voohu Electronic Tech.Co.Ltd</div></div>				<div><div>TITLE: 变压器/TRANSFORMER</div><div>PART NO.: ST0873WH</div><div>REMARK:</div></div>				<div>SIZE A4</div> <div>SACLE 1:1</div> <div>SHEET 2/3</div>	<div>UNITS MM[INCH]</div> <div>REV A0</div> <div></div>	<div>GENERAL TOLERANCES UNLESS SPECIFIED</div> <div><div><div>x±0.35</div><div>.xx±0.25</div><div>.xxx±0.10</div></div><div><div>x°±3.0°</div><div>.xx°±1.5°</div><div>.xxx°±1.0°</div></div></div>	<div>APPROVED BY: Geoffrey.Song</div> <div>CHECKED BY: Elvis.Song</div> <div>DESIGND BY: Sunny.Xu</div>																																						
TEL: +86 400 1048 018		WEB: WWW.WOHU-TEK.COM																																															

- 1.N1绕组不交叉.
- 2.PIN3,4脚同槽进出线.
- 3.N2绕组PIN5,6和7,8各挂2根线.

1		2		3		4		5		6		7		8	
REACH & RoHS COMPLIANT		5. CHARACTERISTIC /电气性能													
		NO. 序号	ITEM 项目	TERT POINT 测试点	TECHNICAL CRITERION 技术标准	TEST CONDITION & INSTRUMENT 测试条件&仪器									
		1	INDUCTANCE 电感	L (2-1)	24uH±10%	CHROMA3250(100Ω) 100KHz/0.1V AT 25℃									
		2	LEAKAGE INDUCTANCE 漏感	LK(2-1) SHORT OTHER PINS	1.0uH MAX	CHROMA3250(100Ω) 100KHz/0.1V AT 25℃									
		3	DCR 直流电阻	R(2-1)	150mΩ MAX	TH2511 AT25℃									
				R(7,8-5,6)	45mΩ MAX										
				R(4-3)	340mΩ MAX										
		4	HI-POT 抗电强度	PRI-SEC	AC1500V	CHROMA19053 1mA 3SEC 50Hz									
				PRI-CORE	AC1000V										
				SEC-CORE	AC1000V										
		5	INSULATION RESISTANCE 绝缘电阻	PRI-SEC	100MΩ MIN	CHROMA19053 DC 500V									
				PRI-CORE	100MΩ MIN										
				SEC-CORE	100MΩ MIN										
		6	RATED POWER 额定功率	额定功率10.8W											
				TITLE: 变压器/TRANSFORMER		SIZE A4	UNITS MM[INCH]	GENERAL TOLERANCES UNLESS SPECIFIED		APPROVED BY: Geoffrey.Song					
<div>VOOHU 苏州沃虎电子科技有限公司</div> <div>Su Zhou Voohu Electronic Tech.Co.Ltd</div>				PART NO.: ST0873WH		SACLE 1:1	REV A0	.xx±0.35	x°±3.0°	CHECKED BY: Elvis.Song					
								.x±0.30	.x°±2.0°						
TEL: +86 400 1048 018		WEB: WWW.WOHU-TEK.COM		REMARK:		SHEET 3/3		.xx±0.25	.xx°±1.5°	DESIGND BY: Sunny.Xu					
								.xxx±0.10	.xxx°±1.0°						
1		2		3		4		5		6		7		8	

Between-20℃ to 80℃ test inductance and resistance on the basis of 25℃,
The variation shall not exceed 20%.
Operating temperature range: -40℃ to +85℃.