

CUSTOMER DRAWING

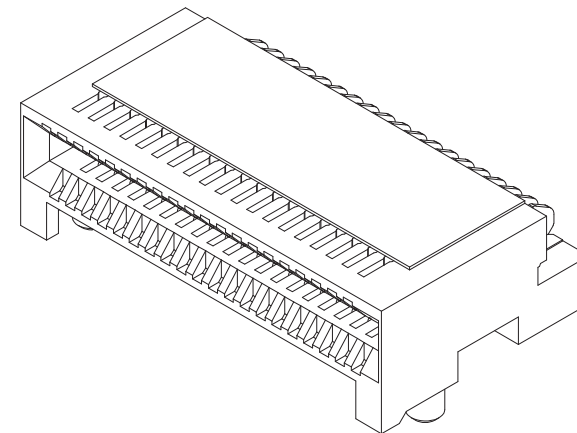
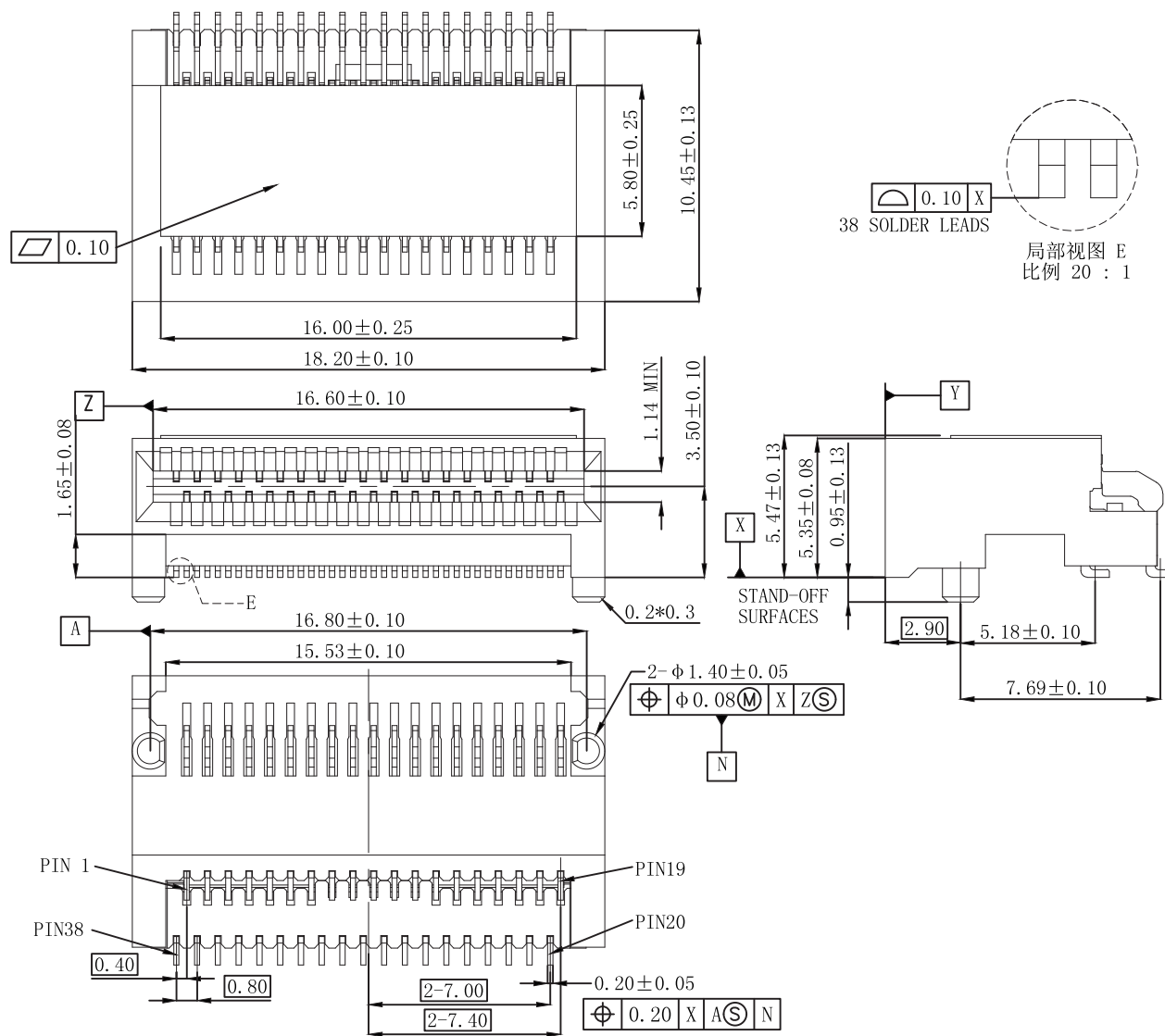

NOTE:

- Material:
HOUSING: HIGH TEMPERATURE LCP, BLACK, UL 94 V-0 FLAME RETARDANT.
- TERMINAL: NICKEL COPPER ALLOY
PLATING SPEC AS BELOW:
OPTION 1
CONTACT AREA PLATE NICKEL 1.27um MIN, PLATE Gold 0.38um MIN
OPTION 2
CONTACT AREA PLATE NICKEL 1.27um MIN, PLATE Gold 0.76um MIN
- ELECTRICAL CHARACTERISTICS
CONTACT CURRENT RATING: 0.5 AMPERE
VOLTAGE RATING: 30VAC
CONTACT RESISTANCE: 30 MILLOHMS MAX
DIELECTRIC WITHSTANDING VOLTAGE: 300VDC
- ENVIRONMENT
OPERATION TEMPERATURE: -40° C TO 85° C

RoHS Compliant

TITLE:
QSFPP+ 1X1 CONNECTOR

PART NO.:
WHSFP20311D005

REMARK:
Gold plated 15u"

SIZE
A4

SACLE
1:1

SHEET
1/3

UNITS
MM[INCH]

REV
A0

GENERAL TOLERANCES
UNLESS SPECIFIED

$x \pm 0.35$	$x^\circ \pm 3.0^\circ$
$.x \pm 0.30$	$.x^\circ \pm 2.0^\circ$
$.xx \pm 0.25$	$.xx^\circ \pm 1.5^\circ$
$.xxx \pm 0.10$	$.xxx^\circ \pm 1.0^\circ$

APPROVED BY:
Geoffrey.Song

CHECKED BY:
Elvis.Song

DESIGND BY:
Sunny.Xu

VOOHU 苏州沃虎电子科技有限公司
Su Zhou Voohu Electronic Tech.Co.Ltd

TEL: +86 400 1048 018

WEB: WWW.WOHU-TEK.COM

CUSTOMER DRAWING

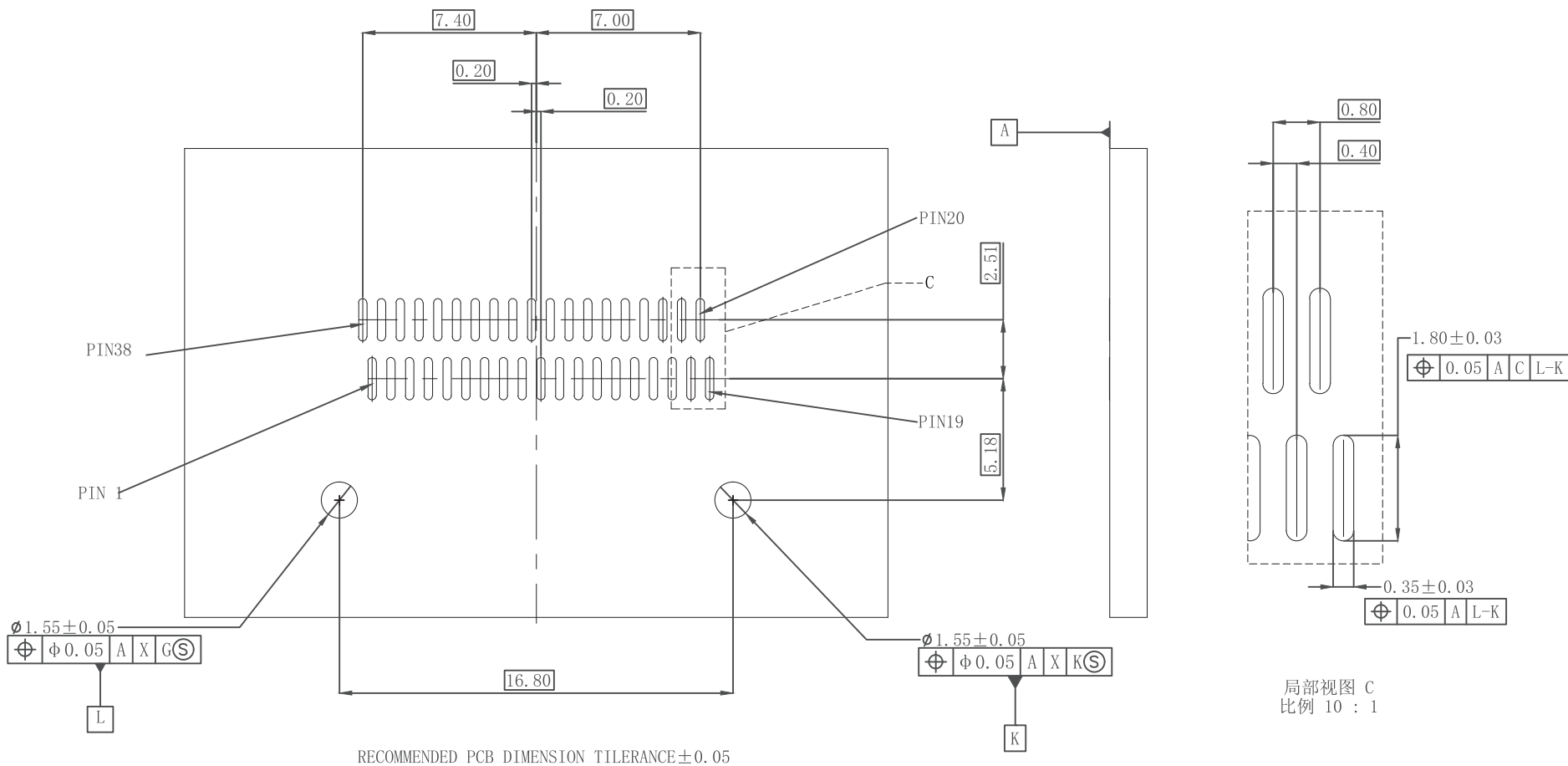

RoHS Compliant

VOOHU 苏州沃虎电子科技有限公司
Su Zhou Voohu Electronic Tech.Co.Ltd

TEL: +86 400 1048 018

WEB: WWW.WOHU-TEK.COM

TITLE:
QSFPP+ 1X1 CONNECTOR

PART NO.:
WHSFP20311D005

REMARK:
Gold plated 15u"

SIZE
A4

SACLE
1:1

SHEET
2/3

UNITS
MM[INCH]

REV
A0

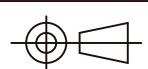

GENERAL TOLERANCES
UNLESS SPECIFIED

$x \pm 0.35$
 $.x \pm 0.30$
 $.xx \pm 0.25$
 $.xxx \pm 0.10$

$x^\circ \pm 3.0^\circ$
 $.x^\circ \pm 2.0^\circ$
 $.xx^\circ \pm 1.5^\circ$
 $.xxx^\circ \pm 1.0^\circ$

APPROVED BY:
Geoffrey.Song

CHECKED BY:
Elvis.Song

DESIGN BY:
Sunny.Xu

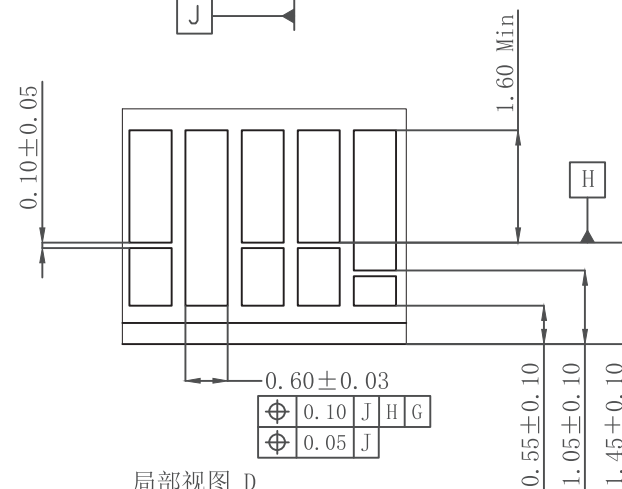
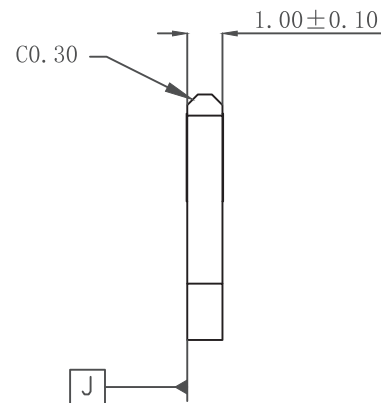

局部视图 D
比例 10 : 1

- A

DESIGND BY:	Sunny.Xu
-------------	----------