

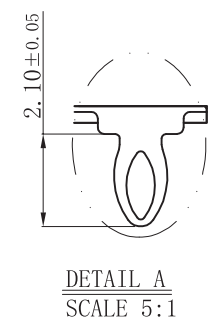

CUSTOMER DRAWING

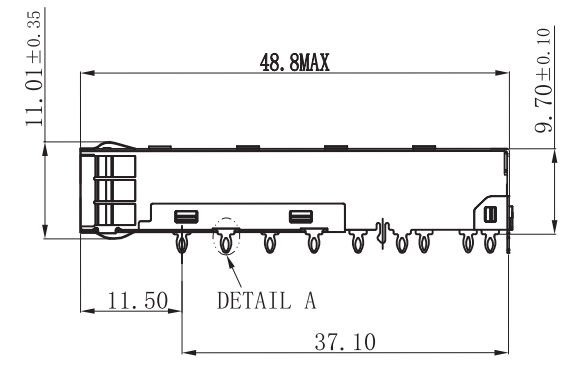
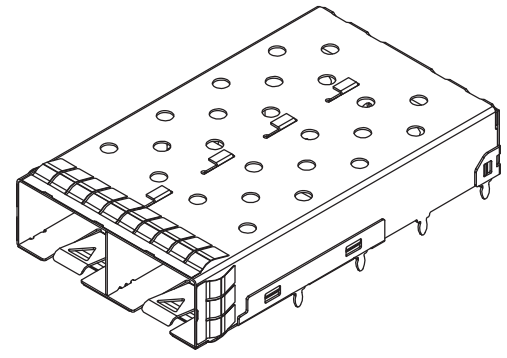
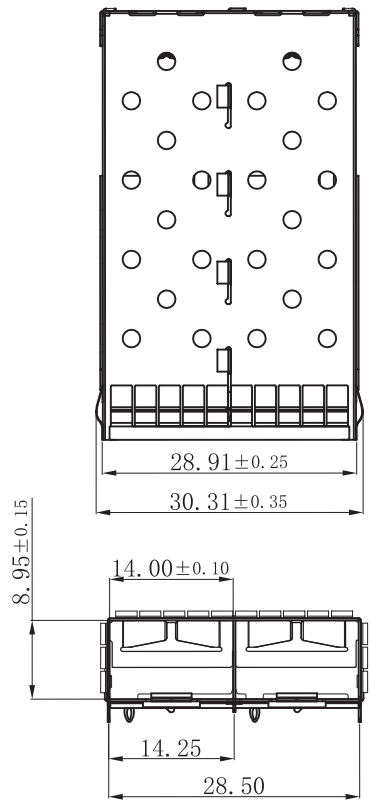

NOTE
1, DESCRIPTION Q' ty MATERIAL PLATING
SFP CAGE 1PCS COPPER ALLOY NI PLATING
SFP EMI SPRINGS 4PCS COPPER ALLOY NI FOR ALL
2, TEMPERATURE:
OPERATION: -40° C~+85° C
STORAGE: -55° C~+105° C

RoHS Compliant

VOOHU 苏州沃虎电子科技有限公司
Su Zhou Voohu Electronic Tech.Co.Ltd

TITLE: SFP+ 1X2 CAGE PRESS FIT	SIZE A4	UNITS MM[INCH]	GENERAL TOLERANCES UNLESS SPECIFIED		APPROVED BY: Geoffrey.Song
PART NO.: WHSFP10612W078	SACLE 1:1	REV A0	x±0.35	x°±3.0°	CHECKED BY:
			.x±0.30	.x°±2.0°	Elvis.Song
REMARK: PLATING NI 30u" MIN	SHEET 1/3		.xx±0.25	.xx°±1.5°	DESIGND BY:
			.xxx±0.10	.xxx°±1.0°	Sunny.Xu

TEL: +86 400 1048 018 WEB: WWW.WOHU-TEK.COM

TITLE:
SFP+ 1X2 CAGE PRESS FIT
PART NO.:
WHSFP10612W078

SIZE A4	UNITS MM[INCH]	GENERAL TOLERANCES UNLESS SPECIFIED	
SACLE 1:1	REV A0	x±0.35	x°±3.0°
		.x±0.30	.x°±2.0°
		.xx±0.25	.xx°±1.5°
		.xxx±0.10	.xxx°±1.0°

CUSTOMER DRAWING

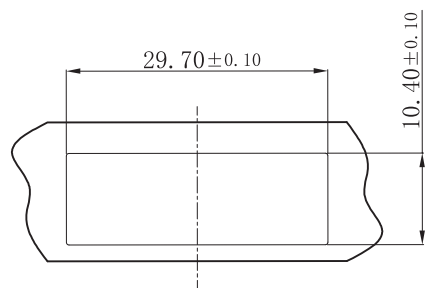

RECOMMENDED BEZEL CUT-OUT SINGLE SIDED APPLICATIONS

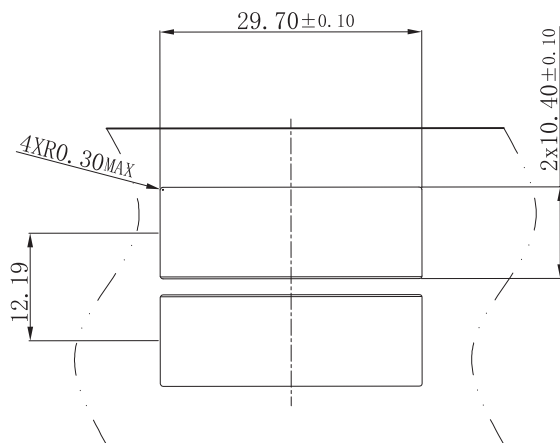

RECOMMENDED BEZEL CUT-OUT SINGLE SIDED APPLICATIONS

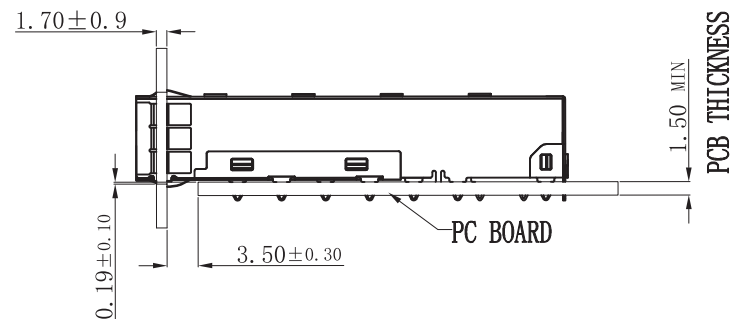

MOUNTED ON PC BOARD
SHOWN THRU RECOMMENDED BEZEL

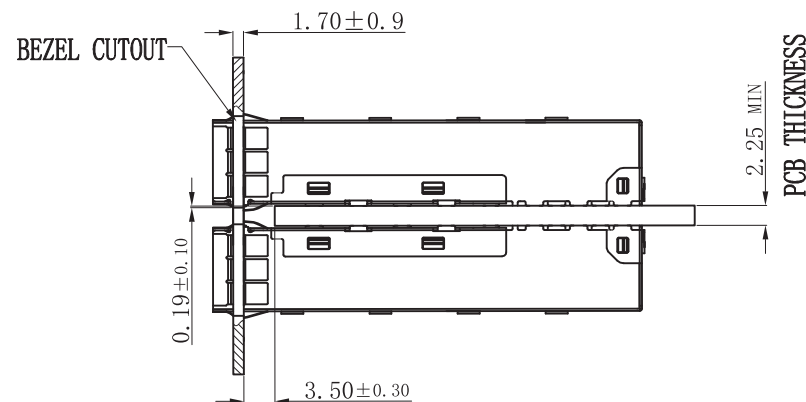

MOUNTED BELLY TO BELLY ON PC BOARD
SHOWN THRU RECOMMENDED BEZEL

RoHS Compliant

VOOHU 苏州沃虎电子科技有限公司
Su Zhou Voohu Electronic Tech.Co.Ltd

TITLE:
SFP+ 1X2 CAGE PRESS FIT

SIZE
A4

UNITS
MM[INCH]

GENERAL TOLERANCES
UNLESS SPECIFIED

APPROVED BY:
Geoffrey.Song

PART NO.:
WHSFP10612W078

SACLE
1:1

REV
A0

$x \pm 0.35$
 $.x \pm 0.30$

$x^\circ \pm 3.0^\circ$
 $.x^\circ \pm 2.0^\circ$

CHECKED BY:
Elvis.Song

TEL: +86 400 1048 018

WEB: WWW.WOHU-TEK.COM

REMARK:
PLATING NI 30u" MIN

SHEET
2/3



$.xx \pm 0.25$
 $.xxx \pm 0.10$

$.xx^\circ \pm 1.5^\circ$
 $.xxx^\circ \pm 1.0^\circ$

DESIGND BY:
Sunny.Xu

CUSTOMER DRAWING

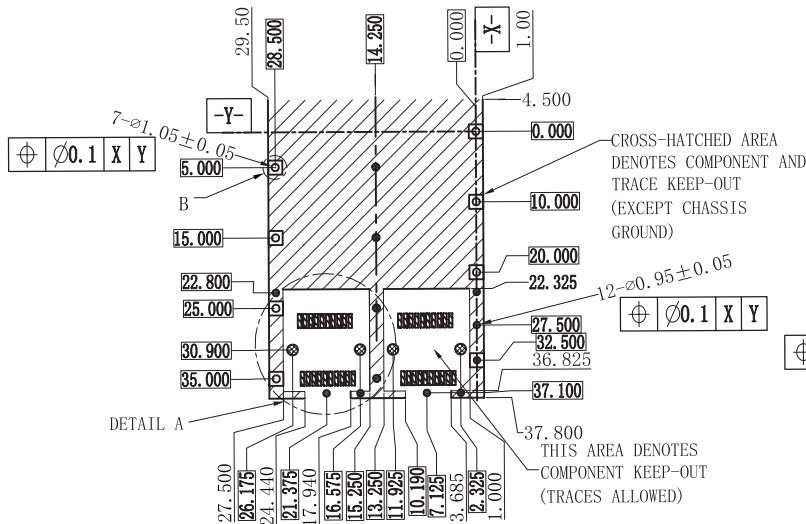

PCB LAYOUT THICKNESS=3.0MM (TOP VIEW)

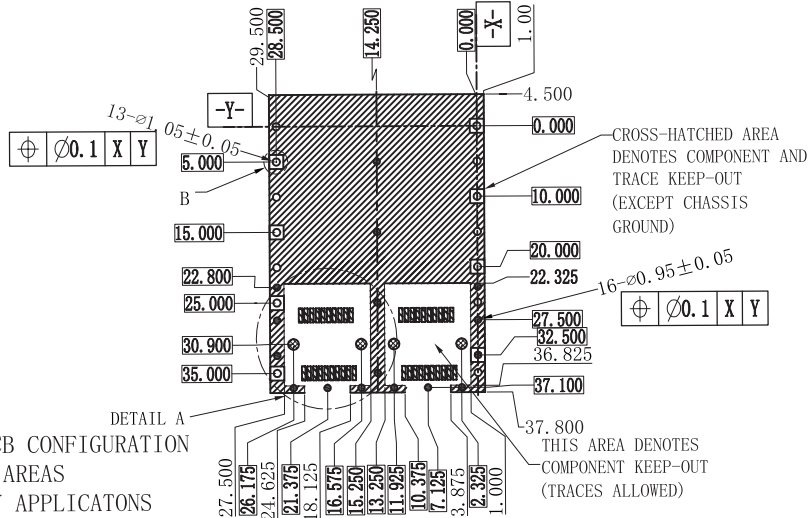

RECOMMENDED PCB CONFIGURATION
WITH KEEP-OUT AREAS
BELLY TO BELLY APPLICATIONS
PCB TOLERANCE: ± 0.05 MM

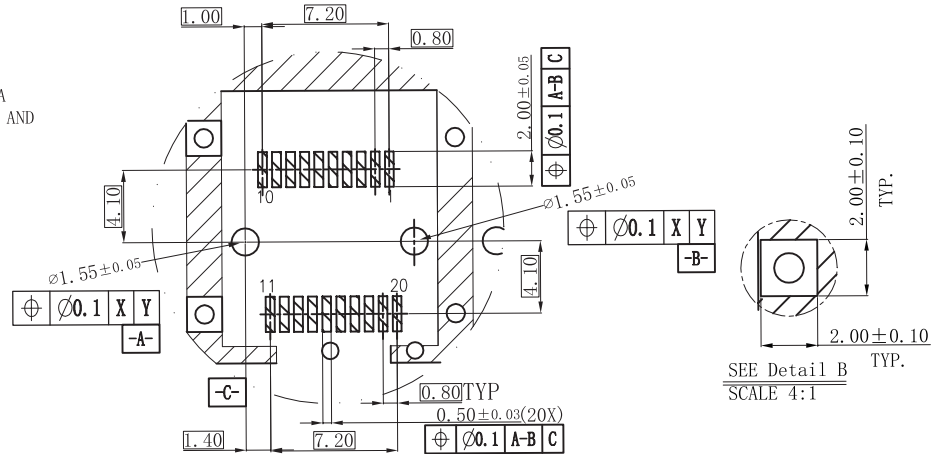

SEE Detail A
SCALE 2.5:1

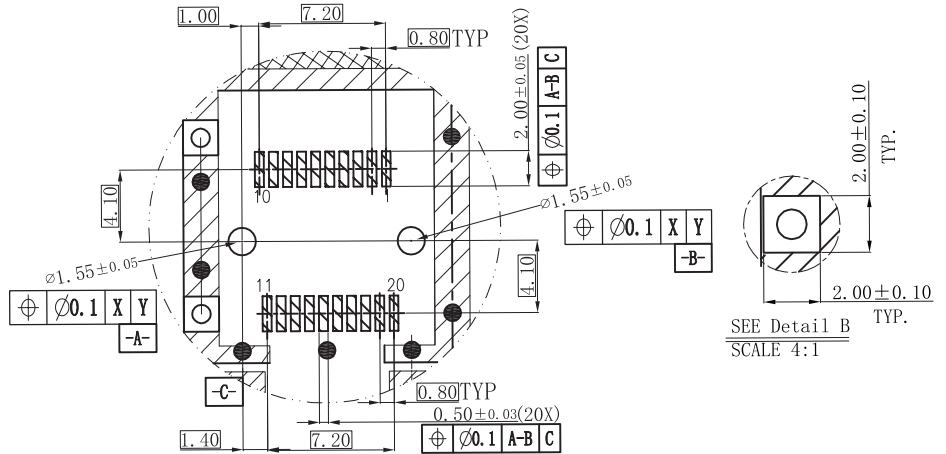

SEE Detail A
SCALE 2.5:1

RoHS Compliant



苏州沃虎电子科技有限公司
Su Zhou Voohu Electronic Tech.Co.Ltd

TITLE:
SFP+ 1X2 CAGE PRESS FIT

PART NO.:
WHSFP10612W078

REMARK:
PLATING NI 30u" MIN

SIZE
A4

SACLE
1:1

SHEET
3/3

UNITS
MM[INCH]

REV
A0

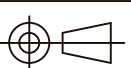

GENERAL TOLERANCES
UNLESS SPECIFIED

$x \pm 0.35$	$x^\circ \pm 3.0^\circ$
$.x \pm 0.30$	$.x^\circ \pm 2.0^\circ$
$.xx \pm 0.25$	$.xx^\circ \pm 1.5^\circ$
$.xxx \pm 0.10$	$.xxx^\circ \pm 1.0^\circ$

APPROVED BY:
Geoffrey.Song

CHECKED BY:
Elvis.Song

DESIGND BY:
Sunny.Xu