

FRONT VIEW

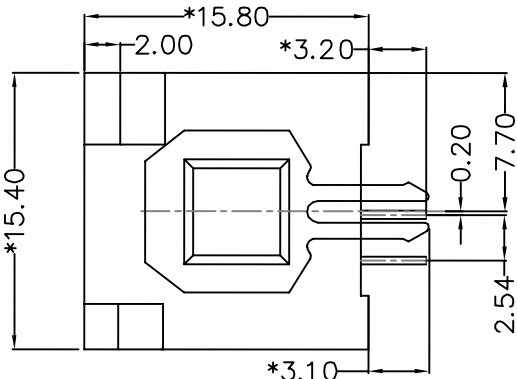

RIGHT SIDE VIEW

MATERIAL:
HOUSING: PBT,UL94V-0,GRAY.
TERMINAL: PHOSPHOR BRONZE Ø=0.45MM, G/FU" GOLD PLATING.
IRON FEET: IRON.

MACHANICAL:
DURABILITY: 750 CYCLES MIN,12.5MM/MINUTE.
INSERTION FORCE: 2.2KG.F MAX.
RETENTION STRENGTH : 7.7KG.F BETWEEN JACK AND PLUG.
OPERATING TEMPERATURE: -40℃~+85℃.
STORAGE TEMPERATURE: -40℃~+85℃.
ALL CRITICAL DIMENSIONS WITH "MM"

ELECTRICAL:
VOLTAGE: 125 VOLTS AC.
CURRENT RATING : 1.5AMP.
DIELECTRIC STRENGTH: 1000 VAC RMS 50HZ OR 60HZ,1MIN.
INSULATION RESISTANCE: 500 MEGA OHMS MIN. INITIAL
AFTER 500V DC FOR 1 MINUTE.
CONTACT RESISTANCE: SINGLE TERMINAL 30 MILLIOHMS MAX.
INITIAL 50 MILLIOHMS MAX. AFTER
DURABILITY TEST.

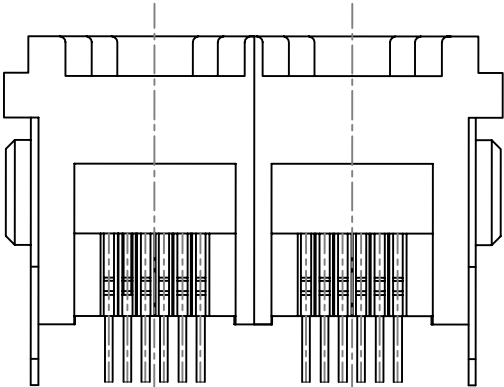

BOTTOM VIEW

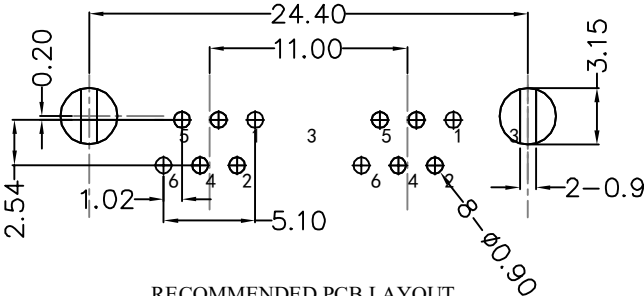

RECOMMENDED PCB LAYOUT
VIEWED FROM COMPONENT SIDE

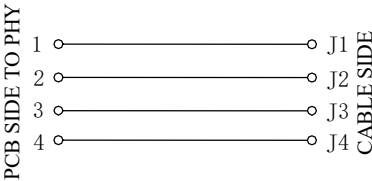

A	<div><div>VOOHU</div><div>苏州沃虎电子科技有限公司</div><div>Su Zhou Voohu Electronic Tech.Co.Ltd</div></div>		TITLE: 5225 6P6C 无灯全塑	SIZE A4	UNITS MM[INCH]	GENERAL TOLERANCES UNLESS SPECIFIED		APPROVED BY: Geoffrey.Song	
			PART NO.: SYT52251266IWE1DY1T095(180° 带铁脚)	SACLE 1:1	REV A0	.x±0.35	x°±3.0°	CHECKED BY: Elvis.Song	
	TEL: +86 400 1048 018		REMARK:	SHEET 1/1		.xx±0.25	.xx°±1.5°	DESIGND BY: Sunny.Xu	
	1	2	3	4	5	6	7	8	