

REACH & RoHS
COMPLIANT

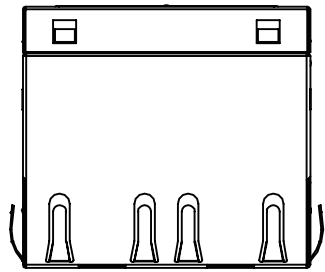

TOP VIEW

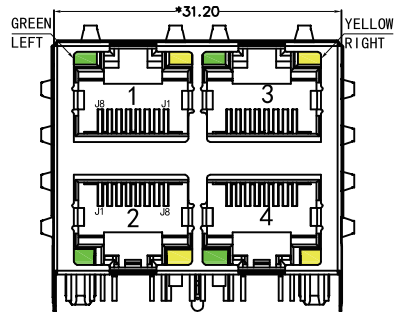

FRONT VIEW

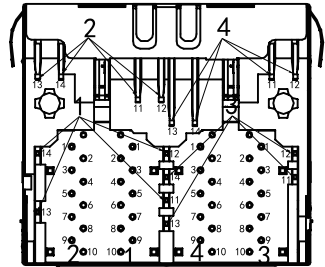

BOTTOM VIEW

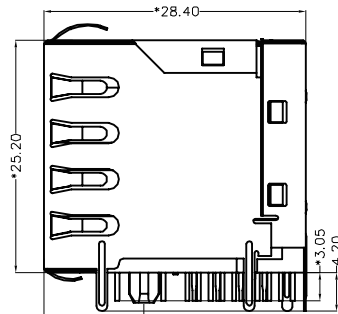

RIGHT SIDE VIEW

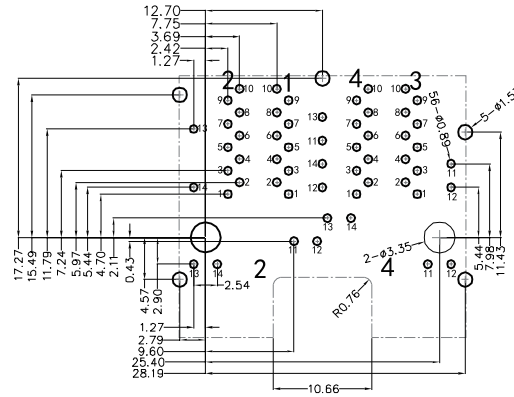

RECOMMENDED PCB LAYOUT
VIEWED FROM COMPONENT SIDE

MATERIAL:

HOUSING: PA66,UL94V-0,BLACK.
TERMINALS BRACKET: PBT,UL94V-0,BLACK.
SHIELD: C2680,T=0.20MM,NICKEL PLATING ON ALL AREA.
TERMINAL: PHOSPHOR BRONZE C5191,T=0.35MM,
30U" GOLD PLATING ON CONTACT AREA.

MECHANICAL:

DURABILITY: 750 CYCLES MIN.
MATING FORCE: 23N MAX.
OPERATING TEMPERATURE: -40°C~+85°C.
STORAGE TEMPERATURE: -40°C~+85°C.
ALL CRITICAL DIMENSIONS WITH "*"

VOOHU 苏州沃虎电子科技有限公司
Su Zhou Voohu Electronic Tech.Co.Ltd

TITLE:
RJ45 2×2 1000BASE

PART NO.:
SYT22Q146DB2A2DB057

REMARK:

SIZE
A4

SACLE
1:1

SHEET
1/3

UNITS
MM[INCH]

REV
A0

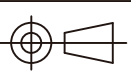

GENERAL TOLERANCES
UNLESS SPECIFIED

$x \pm 0.35$
 $.x \pm 0.30$
 $.xx \pm 0.25$
 $.xxx \pm 0.10$

$x^\circ \pm 3.0^\circ$
 $.x^\circ \pm 2.0^\circ$
 $.xx^\circ \pm 1.5^\circ$
 $.xxx^\circ \pm 1.0^\circ$

APPROVED BY:
Geoffrey.Song

CHECKED BY:
Elvis.Song

DESIGND BY:
Sunny.Xu

TEL: +86 400 1048 018

WEB: WWW.WOHU-TEK.COM

REACH & RoHS
COMPLIANT

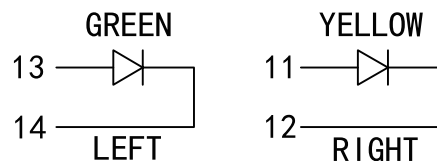
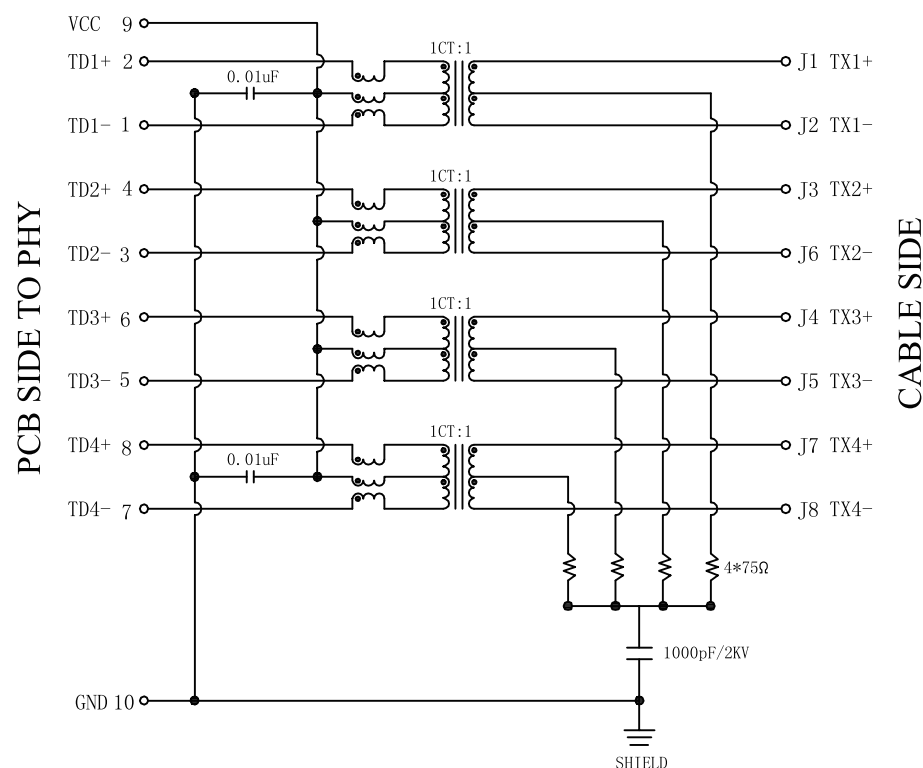

Electrical:

- 1.Turn ratio:2~1:J1~J2=1CT:1CT(±2%).
4~3:J3~J6=1CT:1CT(±2%).
6~5:J4~J5=1CT:1CT(±2%).
8~7:J7~J8=1CT:1CT(±2%).
- 2.OCL:350uH Min.at 100KHz 100mV 8mA DC.
- 3.Insertion Loss: -1.0 dB Max 1~100MHz.
- 4.Return loss: -18dB Min 1~30MHz;
-14dB Min 30~60MHz.
-12dB Min 60~80MHz.
-10dB Min 80~100MHz.
- 5.Cross talk: -40dB Min 1~30MHz;
-35dB Min 30~60MHz;
-30dB Min 60~100MHz;
- 6.CMR: -30dB Min 1~100MHz;
- 7.Hi-Pot:2250V DC 6S 1mA PRI TO SEC

LED Specification

Standard LED Color	LED Wavelength	Foward(A)	Foward(V)
Green	568nm	20mA	1.85-2.45V
Yellow	585nm	20mA	1.7-2.2V

TITLE:
RJ45 2×2 1000BASE

SIZE
A4

UNITS
MM[INCH]

GENERAL TOLERANCES
UNLESS SPECIFIED

APPROVED BY:
Geoffrey.Song

PART NO.:
SYT22Q146DB2A2DB057

SACLE
1:1

REV
A0

.x±0.35
.x±0.30
.xx±0.25
.xxx±0.10

x°±3.0°
.x°±2.0°
.xx°±1.5°
.xxx°±1.0°

CHECKED BY:
Elvis.Song
DESIGND BY:
Sunny.Xu

REMARK:

SHEET
2/3

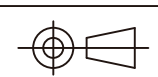

VOOHU 苏州沃虎电子科技有限公司
Su Zhou Voohu Electronic Tech.Co.Ltd

TEL: +86 400 1048 018

WEB: WWW.WOHU-TEK.COM

REACH & RoHS
COMPLIANT

PROFILE OF WAVE SOLDER

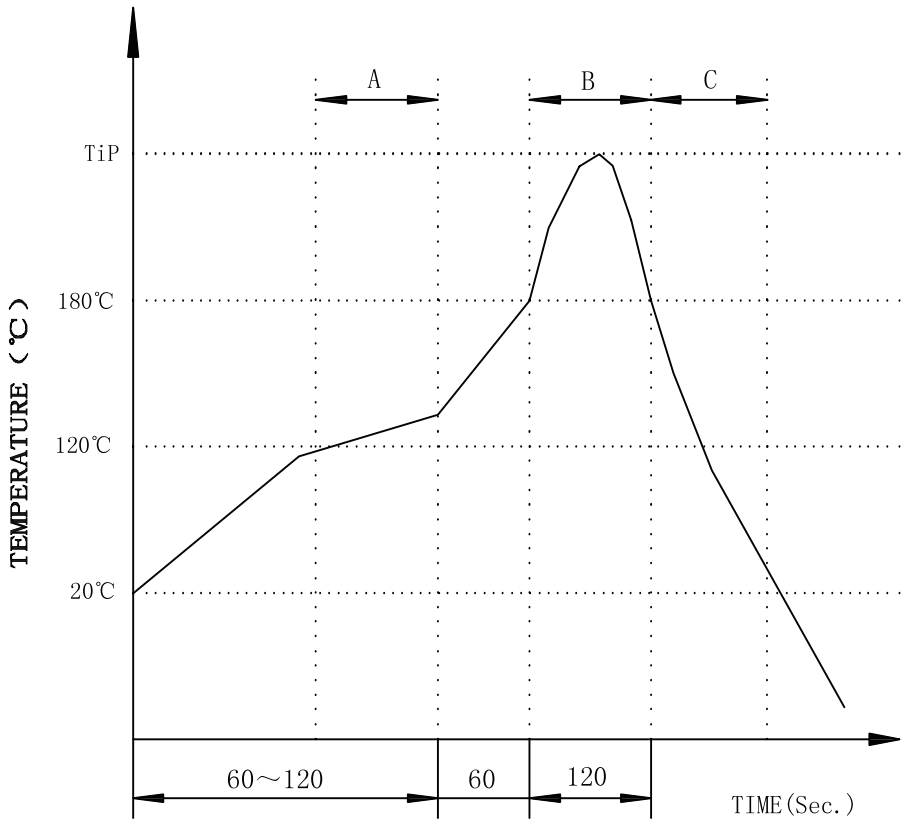

<div>VOOHU</div> <div>苏州沃虎电子科技有限公司</div> <div>Su Zhou Voohu Electronic Tech.Co.Ltd</div>	TITLE: RJ45 2×2 1000BASE		SIZE A4	UNITS MM[INCH]	GENERAL TOLERANCES UNLESS SPECIFIED		APPROVED BY: Geoffrey.Song
	PART NO.: SYT22Q146DB2A2DB057		SACLE 1:1	REV A0	.xx±0.35 .x°±3.0°	.xx°±1.5°	CHECKED BY: Elvis.Song
	REMARK:		SHEET 3/3		.xx±0.25 .xxx°±1.0°	.xxx°±1.0°	DESIGND BY: Sunny.Xu