

REACH & RoHS
COMPLIANT

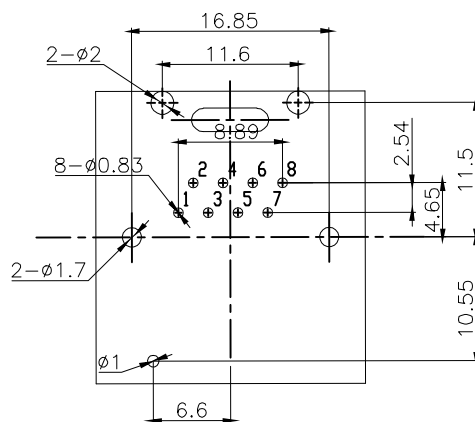
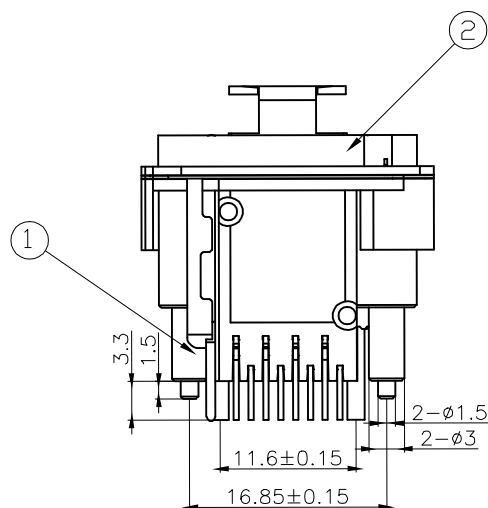
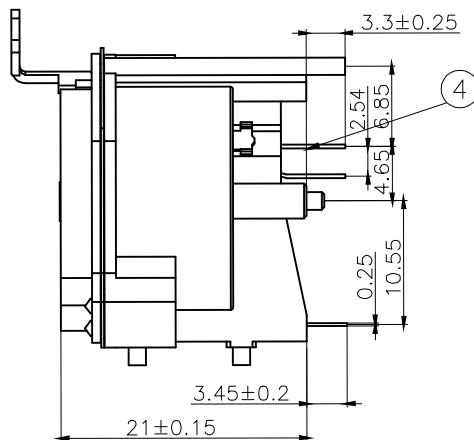
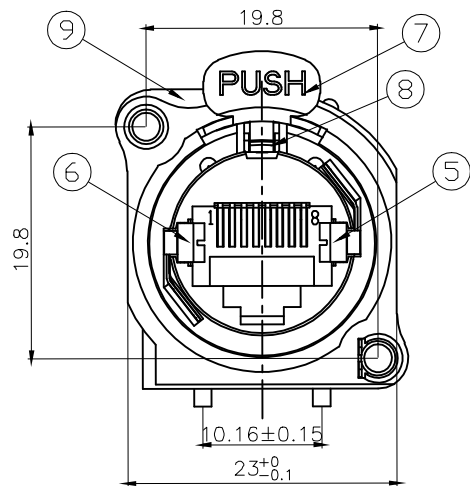

PCB LAYOUT
RECOMMENDED

General Specification
Current Rating: 1.5A DC /Contact, 20mA DC for LED signals
Voltage Rating: 125V AC /Contact, 2.0 volts DC for LED signals
Operating Environment
Standard Temperature: -20°C~+70°C
Industrial Temperature: -40°C~+85°C
Humidity: 20~70%
Contact Resistance: ≤30mΩ
Insulation Resistance: ≥500MΩ
Dielectric Strength: 500V AC/(50HZ)/Min
Mating And unmating Force: 3~20N
Durability: 750 Cycles Min

Material Specification
Housing :Thermo-plastic, UL94V-0.
Contact :Alloy Copper
Shield :Alloy Copper
Please refer to the customer drawing when customer has specified

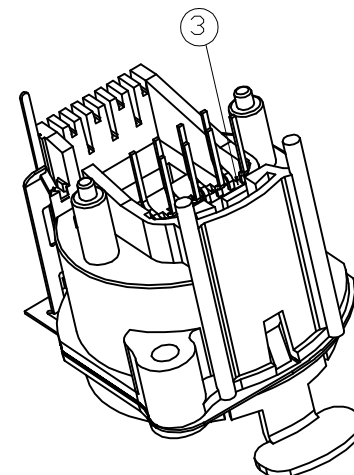

9	shield	H62	1	NI	
8	Right shrapnel	H62	1	MI	
7	Left shrapnel	H62	1	MI	
6	Press handle	stainless steel	1	NI	
5	Shrapnel	manganese steel	1	NI	
4	back cover	LCP	1	BLACK	
3	Metal panel	kirsite	1	nickel	
2	PIN INSERTION	PHOSPHOR BRONZE	8	1U"	
1	PLASTIC BASE	PA66	1	BLACK	
SERIAL NUMBER	NAME	MATERIALS	QUANTITY	COATING/ COLOUR	NOTES

VOOHU 苏州沃虎电子科技有限公司
Su Zhou Voohu Electronic Tech.Co.Ltd

TITLE:
Awith lock 180° Metal panel

SIZE
A4

UNITS
MM[INCH]

GENERAL TOLERANCES
UNLESS SPECIFIED

APPROVED BY:
Geoffrey.Song

PART NO.:
WHA80001051AB33

SACLE
1:1

REV
A0

x±0.35
.x±0.30

x°±3.0°
.x°±2.0°

CHECKED BY:
Elvis.Song

TEL: +86 400 1048 018

WEB: WWW.WOHU-TEK.COM

REMARK:

SHEET
1/1

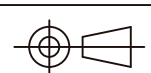

.xx±0.25
.xxx±0.10

.xx°±1.5°
.xxx°±1.0°

DESIGND BY:
Sunny.Xu