

REACH & RoHS
COMPLIANT

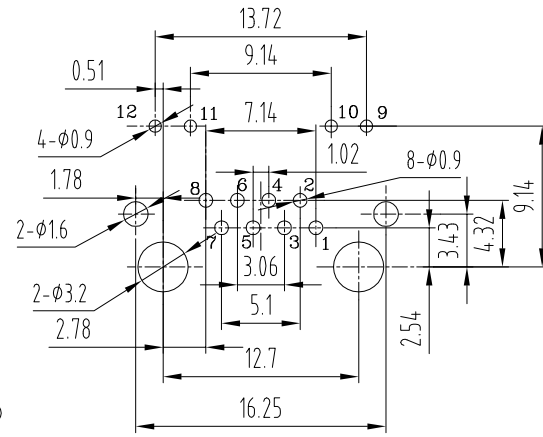

RECOMMENDED PC BOARD LAYOUT PCB THICKNESS=1.6mm
AS VIEWED FROM COMPONENT SIDE TOLERANCE 0.05mm

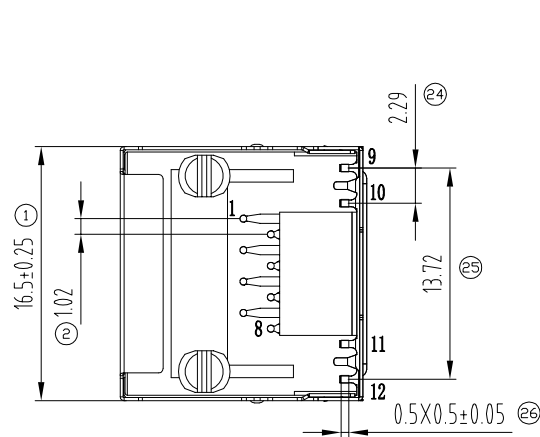
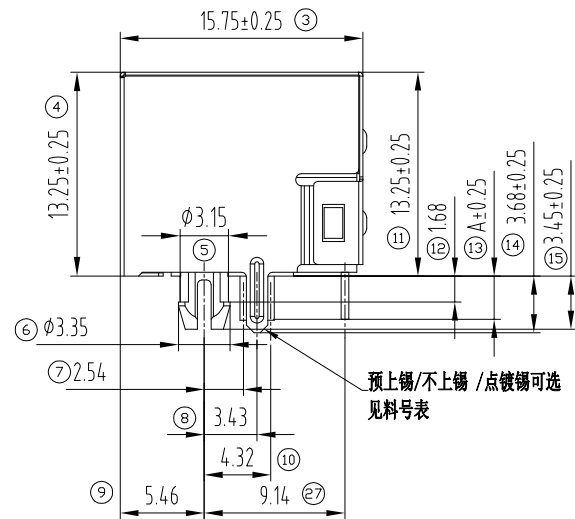

预上锡/不上锡/点镀锡可选
见料号表

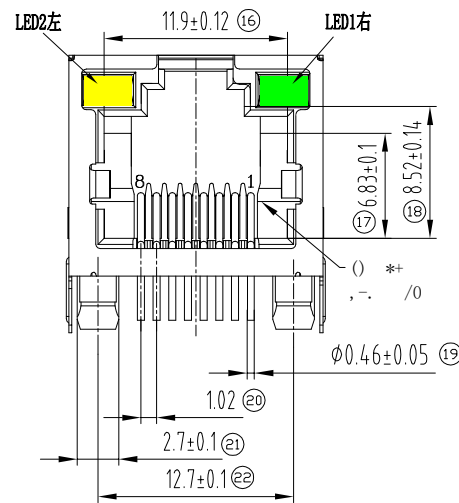

MATERIAL:

HOUSING: PA46,UL94V-0,BLACK.
TERMINAL: PHOSPHOR BRONZE $\phi=0.46\text{MM}$, G/FU" GOLD PLATING.
SHIELD: C2680,T=0.20MM,20U" MIN NICKEL PLATING
ON ALL AREA.

MACHANICAL:

DURABILITY: 750 CYCLES MIN,12.5MM/MINUTE.
INSERTION FORCE: 2.2KG.F MAX.
RETENTION STRENGTH : 7.7KG.F BETWEEN JACK AND PLUG.
OPERATING TEMPERATURE: -55°C~+125°C.
STORAGE TEMPERATURE: -55°C~+125°C.
ALL CRITICAL DIMENSIONS WITH "**"

ELECTRICAL:

VOLTAGE: 125 VOLTS AC.
CURRENT RATING : 1.5AMP.
DIELECTRIC STRENGTH: 1000 VAC RMS 50HZ OR 60HZ,1MIN.
INSULATION RESISTANCE: 500 MEGA OHMS MIN. INITIAL
AFTER 500V DC FOR 1 MINUTE.
CONTACT RESISTANCE: SINGLE TERMINAL 30 MILLIOHMS MAX.
INITIAL 50 MILLIOHMS MAX. AFTER
DURABILITY TEST.

LED Specification

Standard LED Color	LED Wavelength	Foward(A)	Foward(V)
Green	568nm	20mA	1.8-2.8V
Yellow	585nm	20mA	1.8-2.8V

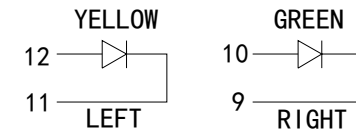

VOOHU 苏州沃虎电子科技有限公司
Su Zhou Voohu Electronic Tech.Co.Ltd

TEL: +86 400 1048 018

WEB: WWW.WOHU-TEK.COM

TITLE:
RJ45直通 56带屏蔽带灯

PART NO.:
SYT561188AB1A3DY1027

REMARK:

SIZE
A4

SACLE
1:1

SHEET
1/1

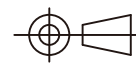

UNITS
MM[INCH]

REV
A0

GENERAL TOLERANCES
UNLESS SPECIFIED

$x\pm0.35$	$x^{\circ}\pm3.0^{\circ}$
$.x\pm0.30$	$.x^{\circ}\pm2.0^{\circ}$
$.xx\pm0.25$	$.xx^{\circ}\pm1.5^{\circ}$
$.xxx\pm0.10$	$.xxx^{\circ}\pm1.0^{\circ}$

APPROVED BY:
Geoffrey.Song

CHECKED BY:
Elvis.Song

DESIGND BY:
Sunny.Xu