

REACH & RoHS
COMPLIANT

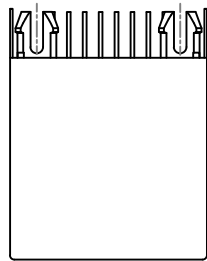

TOP VIEW

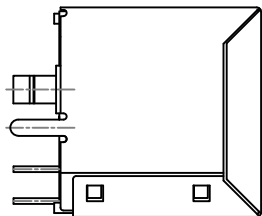

LEFT SIDE VIEW

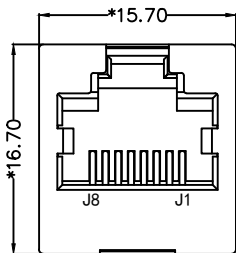

FRONT VIEW

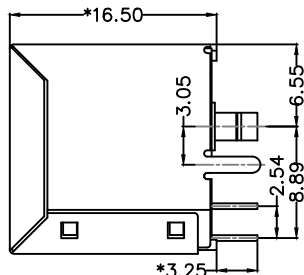

RIGHT SIDE VIEW

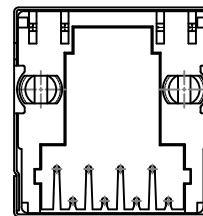

BACK VIEW

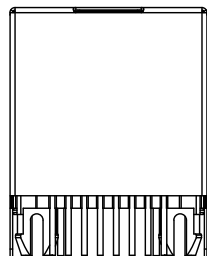

BOTTOM VIEW

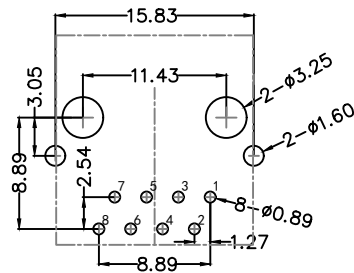

RECOMMENDED PCB LAYOUT
VIEWED FROM COMPONENT SIDE

MATERIAL:

HOUSING: PBT,UL94V-0,BLACK.
TERMINAL: PHOSPHOR BRONZE $\varnothing=0.46\text{MM}$, 3U" GOLD PLATING.
SHIELD: C2680,T=0.20MM,20U" MIN NICKEL PLATING
ON ALL AREA.

MACHANICAL:

DURABILITY: 750 CYCLES MIN,12.5MM/MINUTE.
INSERTION FORCE: 2.2KG.F MAX.
RETENTION STRENGTH : 7.7KG.F BETWEEN JACK AND PLUG.
OPERATING TEMPERATURE: $-40^{\circ}\text{C}\sim+85^{\circ}\text{C}$.
STORAGE TEMPERATURE: $-40^{\circ}\text{C}\sim+85^{\circ}\text{C}$.
ALL CRITICAL DIMENSIONS WITH "*"

ELECTRICAL:

VOLTAGE: 125 VOLTS AC.
CURRENT RATING : 1.5AMP.
DIELECTRIC STRENGTH: 1000 VAC RMS 50HZ OR 60HZ,1MIN.
INSULATION RESISTANCE: 500 MEGA OHMS MIN. INITIAL
AFTER 500V DC FOR 1 MINUTE.
CONTACT RESISTANCE: SINGLE TERMINAL 30 MILLIOHMS MAX.
INITIAL 50 MILLIOHMS MAX. AFTER
DURABILITY TEST.

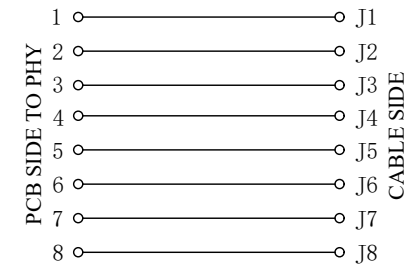

VOOHU 苏州沃虎电子科技有限公司
Su Zhou Voohu ElectronicTech.Co.Ltd

TITLE:
180° TAB-UP

PART NO.:
SYT52241188GWA1DY38022

REMARK:

SIZE
A4

SACLE
1:1

SHEET
1/2

UNITS
MM[INCH]

REV
A2

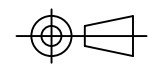

GENERAL TOLERANCES
UNLESS SPECIFIED

$x\pm0.35$	$x^{\circ}\pm3.0^{\circ}$
$.x\pm0.30$	$.x^{\circ}\pm2.0^{\circ}$
$.xx\pm0.25$	$.xx^{\circ}\pm1.5^{\circ}$
$.xxx\pm0.10$	$.xxx^{\circ}\pm1.0^{\circ}$

APPROVED BY:
Geoffrey.Song

CHECKED BY:
Elvis.Song

DESIGND BY:
Sunny.Xu

TEL: +86 400 1048 018

WEB:www.wohu-tek.com